



## How to use Microsoft Remote Desktop for iOS

### PURPOSE:

- How to connect to Cisco AnyConnect VPN
- How to configure and connect to Remote Desktop for iOS
- How to disconnect from a Remote Desktop for iOS

### HOW TO USE MICROSOFT REMOTE DESKTOP FOR iOS:

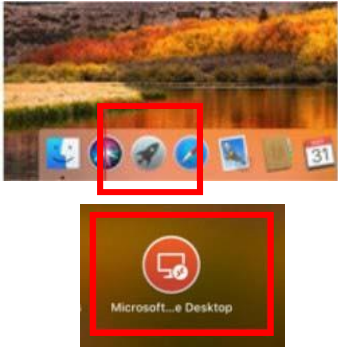
<p>Verify CISCO AnyConnect VPN is on.</p> <p>Launch the application and note if it states “Connected” or “Disconnected”. If disconnected, verify the VPN server is entered as <b>vpn01.cu.edu</b> and connect using your normal system credentials.</p>	
<p>Log into the VPN using your portal credentials.</p> <p>Use your normal CU system credentials to connect to the VPN.</p>	
<p>Open Microsoft Remote Desktop Connection through the Launchpad</p> <p>Navigate to the Launchpad, which has a rocket logo.</p> <p>Once open, select the Microsoft Remote Desktop.</p>	

To begin a new connection:

Select the New/+ sign on the Microsoft Remote Desktop window.

Under "PC Name", enter the Device Name you are remoting into.

Type your system credentials in using the following format:

Username: AD\systemusername

Password: your regular system password

Once entered, close out the window.

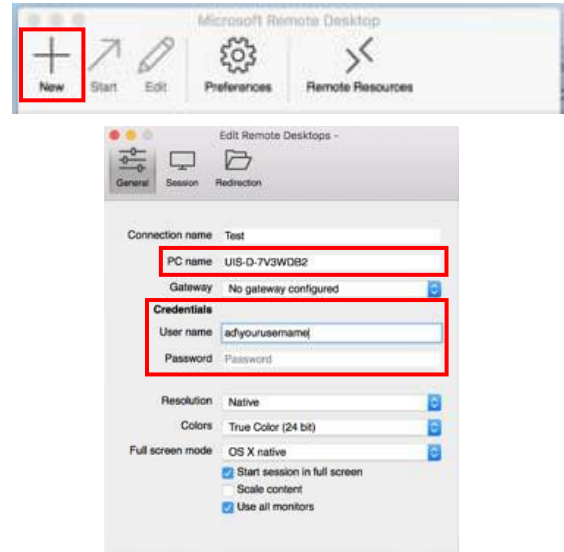

To launch your new connection to the remote desktop, double click on the computer name in the Remote Desktop app.

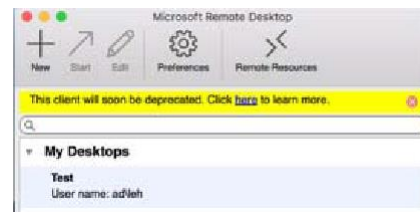

You must accept the certificate in order to connect to your computer. When prompted, accept the connection certificates by clicking "Continue".

You are now connected to your remote desktop!

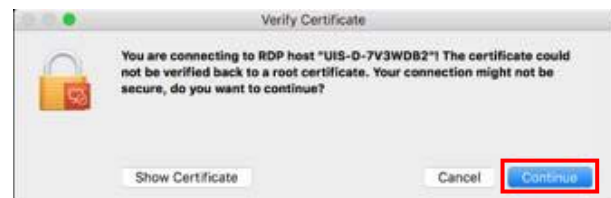

There are two ways to disconnect from the Remote Desktop:

To disconnect and end the session, close the Remote Desktop window on your Mac. This can be done by selecting Microsoft Remote Desktop from the top menu and selecting "Quit Microsoft Remote Desktop".

Closing the application this way automatically locks the remote machine for security.

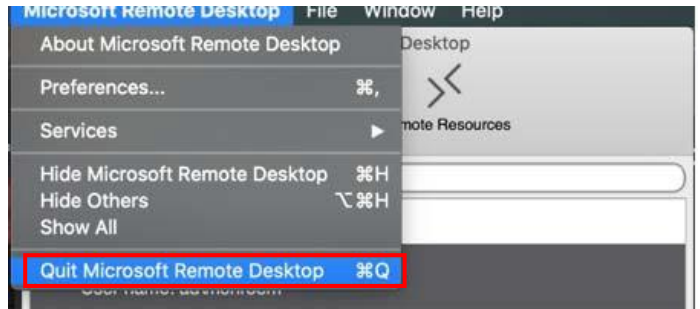

You can also sign out of your remote machine, using the normal sign out method and then closing the Remote Desktop Application using the instructions above.

To sign out:

1. Select the Start button
2. Select the Account icon (or picture)
3. Select Sign out

You have now disconnected from your Remote Desktop session and left the remote computer in a state that will be accessible the next time you want to login.

