

How to Connect to Eduroam Wireless on Android

PURPOSE:

- How to Connect to Eduroam Wireless using Android 9 Pie

From the home screen, begin by swiping down from the top to show the Quick Settings Menu.

Long press on the **Wi-Fi icon** in the top left to show the Wi-Fi settings menu and available Wi-Fi networks.

Alternatively, open **Settings** from the **App Drawer**, click on **Network & Internet** and then choose **Wi-Fi**.

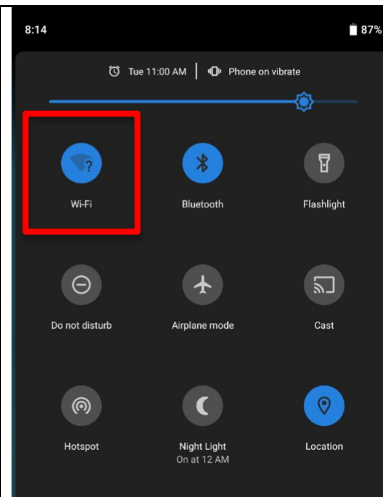

Select **eduroam** from the menu.

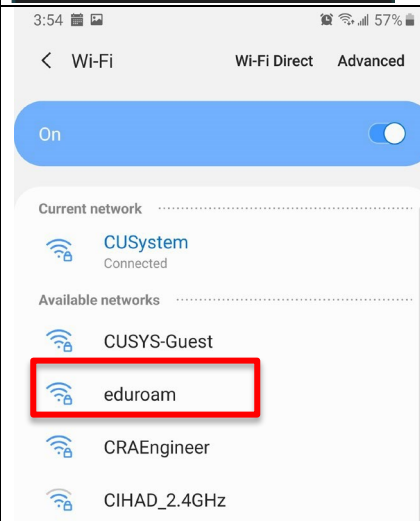

University of Colorado

Boulder | Colorado Springs | Denver | Anschutz Medical Campus

UNIVERSITY INFORMATION SERVICES

Contact UIS

Call: (303) 860 4357

Email: help@cu.edu

To connect, enter the following information:

- Ensure that the EAP method is set to **PEAP**
- Phase 2 authentication is **MSCHAPV2**
- CA Certificate is set to **Use system certificates**
- Online certificate status is set to **Do not verify**
- Domain is **cu.edu**
- Identity is your **account username (e.g., smithj)**
- Anonymous Identity can be left blank
- Password is your **account password**

Once the information above matches the example, click **Connect**, and the screen should change to show the network connecting.

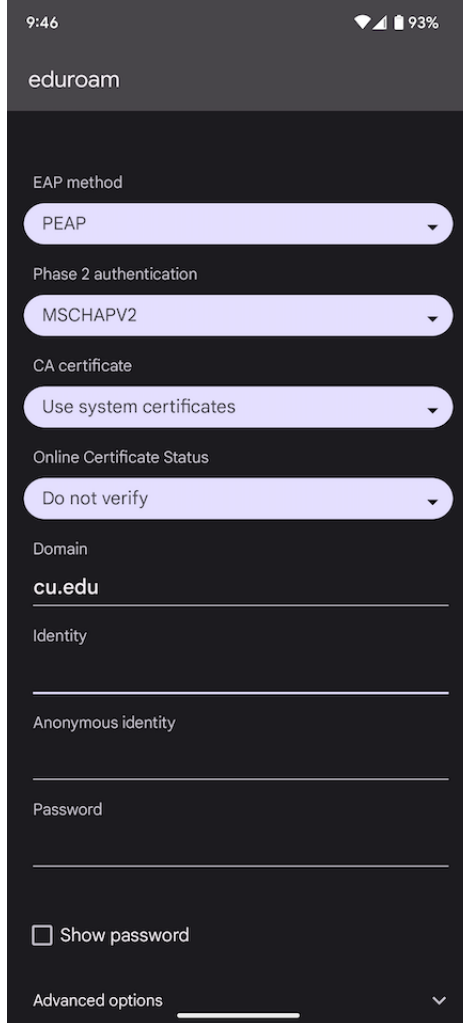

You have connected your device to the eduroam Wi-Fi when you see the words **Connected** under eduroam.

Please follow best practices in browsing and security.

